

Motores abertos

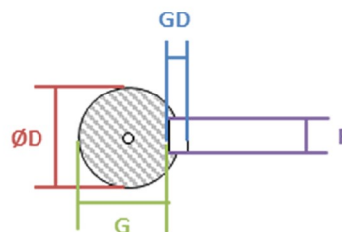

PONTA DE EIXO

CARCAÇA NEMA 56	H	E	F	G	ØD	GD	ROLAMENTO DIANTEIRO	ROLAMENTO TRASEIRO
A56	88,90	47,60	4,76	13,10	15,88	4,76	6204 ZZ	6203 ZZ
B56	88,90	47,60	4,76	13,10	15,88	4,76	6204 ZZ	6203 ZZ
D56	88,90	57,10	4,76	16,30	19,05	4,76	6204 ZZ	6203 ZZ
F56H	88,90	57,10	4,76	16,30	19,05	4,76	6204 ZZ	6203 ZZ

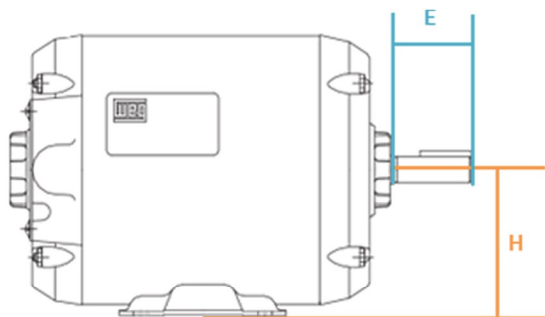
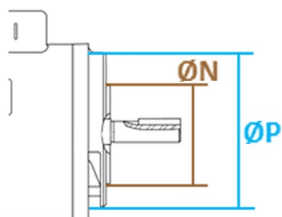
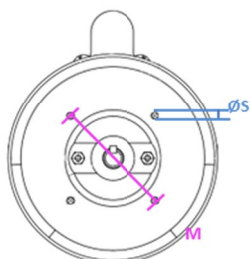

CARCAÇA NEMA 56	FLANGE C-DIN	ØS (mm)	M (mm)	ØN (mm)	ØP (mm)
56	FC-95	4 XUNC 3/8" - 16	95,2	76,2	143,0

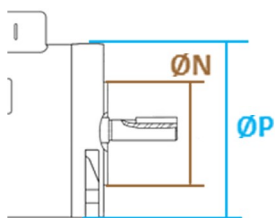
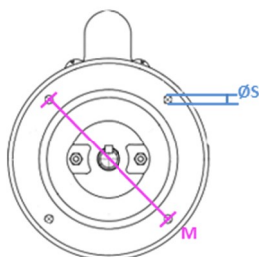

CARCAÇA NEMA 56	FLANGE C-DIN	ØS (mm)	M (mm)	ØN (mm)	ØP (mm)
56	FC-149	4 XUNC 1/4" - 20	149,2	114,3	165,0

